

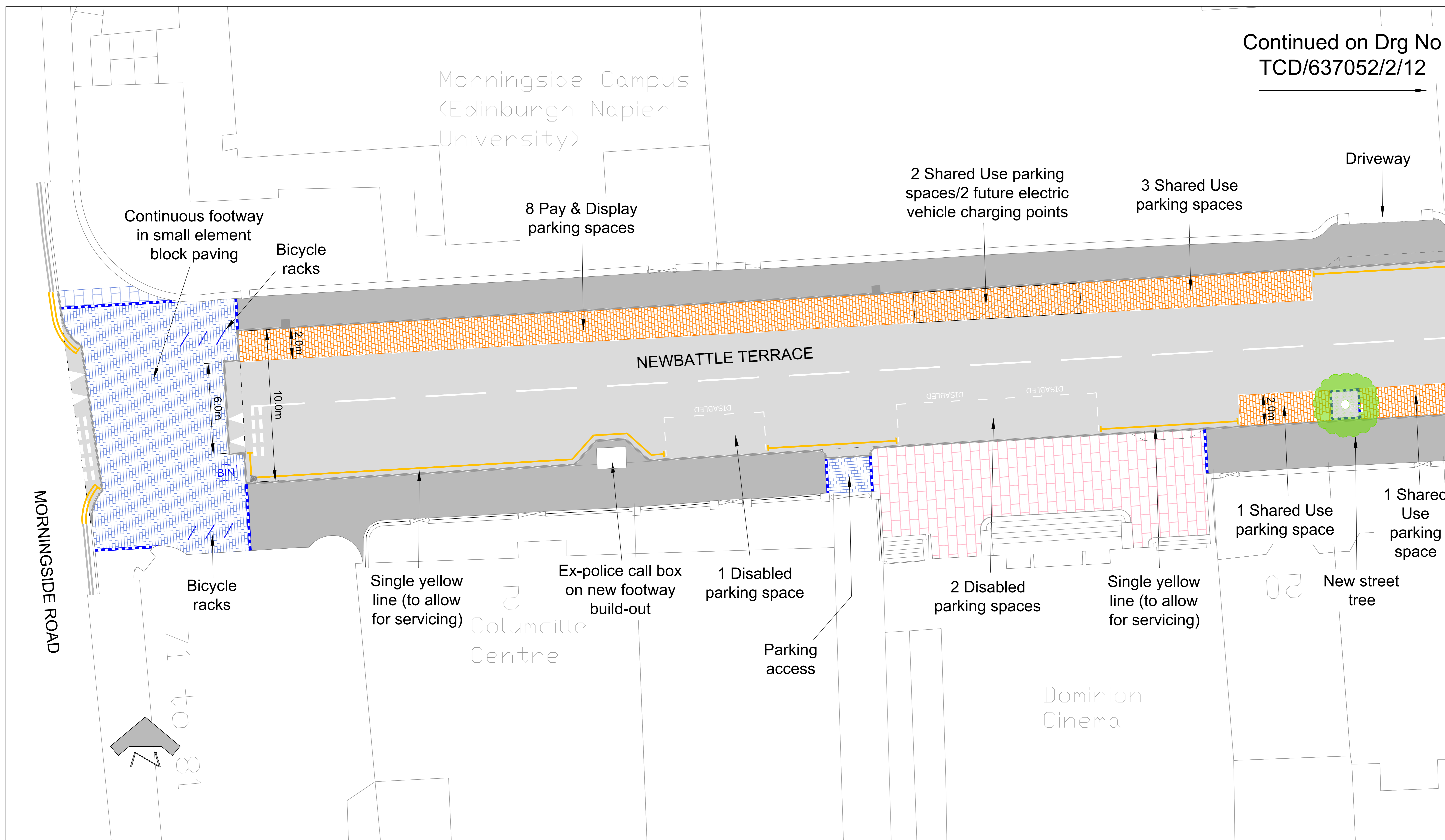

NOTES:

- Asphalt carriageway
- Asphalt footway
- PCC slab footway
- Natural stone footway
- Natural stone sett-paved parking areas
- Small element block paved area
- Natural stone kerbline
- Natural stone edging kerbline
- White road markings
- Waiting/loading restriction markings
- Vehicle crossover
- Drop kerb pedestrian crossing



Continued on Drg No
TCD/637052/2/12

This map is reproduced from Ordnance Survey material with the permission of Ordnance Survey on behalf of the Controller of Her Majesty's Stationery Office © Crown copyright. Unauthorised reproduction infringes Crown copyright and may lead to prosecution or civil proceedings.
100023420 (2020)

B	Final scheme layout	AP	Sept 2020	TB
A	Pay & Display parking spaces amended to Shared Use	AP	Aug 2020	TB
REVISION	DETAILS	BY	DATE	CHECKED

EDINBURGH
THE CITY OF EDINBURGH COUNCIL

The City of Edinburgh Council
Waverley Court
4 East Market Street
Edinburgh, EH8 8BG
Telephone: 0131 200 2000

PLACE MANAGEMENT
ROADS AND TRANSPORT INFRASTRUCTURE
TRANSPORT CONTRACTS AND DESIGN

Newbattle Terrace
Carriageway and Footway Resurfacing
Public Realm Works
Public Consultation 2020
Drawing 1 of 4

Date: August 2020
Scale: 1:100 / 1:500 @A0
Job No. 637052
Drawn by: A Parkinson
Checked by: T Booth